

For Patent Information go to <https://goo.gl/2z62aS>

SLXTM PRISM SCOPES **3x32 GEN III / 5x36 GEN III**

SCOPE MANUAL

Thank you for choosing this Primary Arms optic.

If you have any questions about your new optic or any of our other products, visit us at www.primaryarmsoptics.com, email us at info@primaryarmsoptics.com, or give us a call toll-free at 855-774-2767. The customer service team at our headquarters in Houston, Texas will respond promptly.

If you have any problems with a Primary Arms product, we urge you to contact us immediately and let our customer service professionals handle the situation for you. There is no need to return your optic to the retailer.

*View back cover for lifetime warranty information.

TABLE OF CONTENTS

Page 3	Introducing: Primary Arms SLx Gen III Prism Scopes
Page 4	Removable Base & Spacer
Page 5	Achieving a Clear Reticle Picture PLEASE READ THIS FIRST
Page 6	Reticle Illumination
Page 8	Zeroing
Page 9	Specifications
Page 10	Features

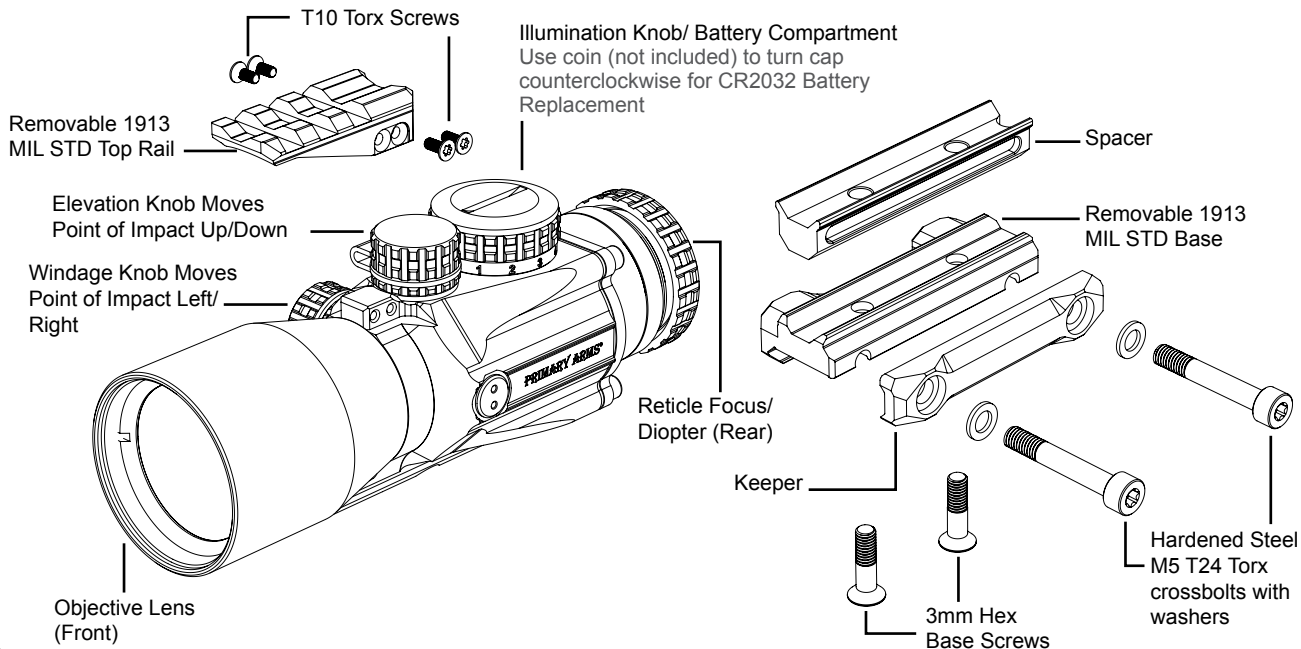

PRIMARY ARMS SLx 3x32 & 5x36 GEN III PRISM SCOPE

Generation 3 SLx Prism Scopes represent our next innovative iteration of our ruggedized prism optics. All the beloved features of our 2nd generation optics are maintained, while several improvements have been made to further enhance the optic's precision and performance in adverse conditions. The first enhancement comes with the mounting system. Gen 3 SLx Prism Scopes come with a brand-new factory mount, which utilizes high-strength steel hardware for superior torque and zero retention. These mounts are lightweight and robust but occupy a minimal footprint, making them suitable for any rifle setup. In addition to the new mounts, the reticles have been updated with new options with center chevrons, which provide an infinitely precise point of aim.

GEN III PRISM SCOPE BODY

3x32

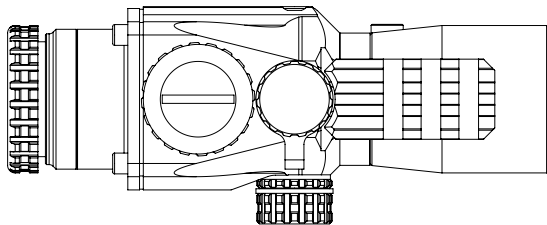

5x36

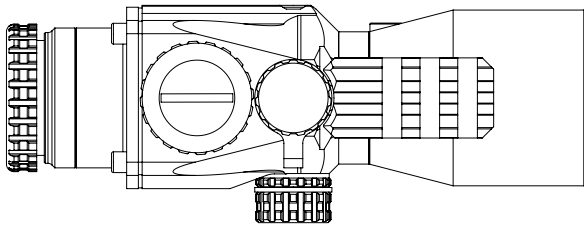

THE REMOVEABLE BASE AND SPACER

Thread locker is recommended on the base and accessory rail screws. The 3mm hex base screws may be removed for use with AR-15 carry handle upper receivers in conjunction with our Steel Knurled Head Thumb Screw, part no: 92581A320.

The Compact Prism Scope features a removable spacer in between the base and the scope body. Use the spacer for firearms with straight line stocks such as AR-15s. Removing the spacer brings the scope body lower for use with firearms with stocks located lower than the receiver, like AK-47s. The scope body is compatible with full size industry-standard style mounts with or without the spacer installed.

THE REMOVEABLE 1913 MIL STD RAIL

The top mounted 1913 MIL STD rail is useful for mounting a reflex sight or other accessories above the compact prism scope. It is removable by turning the four T10 torx screws counterclockwise and removing them. Removing the 1913 rail shaves a bit of weight and bulk from the scope. To replace the 1913 rail, torque the screws to only 5 inch pounds after applying a small amount of blue thread locker. Do not overtighten the screws, this is a very small amount of torque!

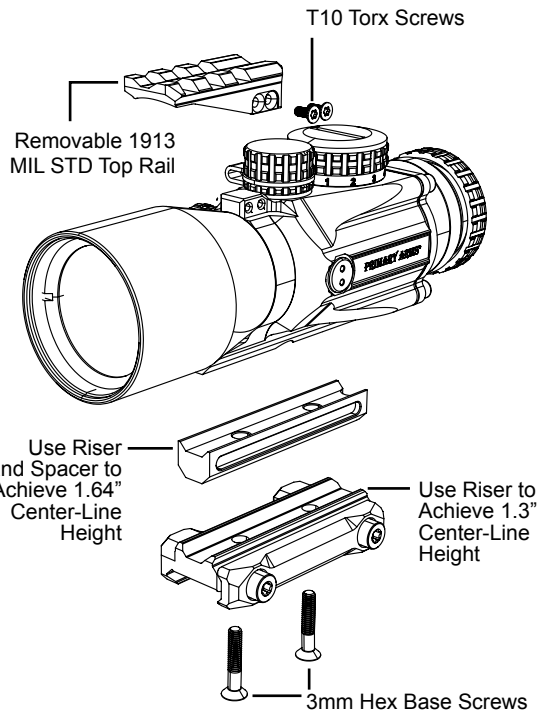

HOW TO ACHIEVE A CLEAR RETICLE PICTURE

Setting the adjustable diopter ring at the rear of the eyepiece is a critical first step to successful precision shooting. Looking at a featureless light background like a clear blue sky or blank wall, the reticle should appear sharp and crisp. If it does not, you need to adjust by turning the diopter ring. Look at the scope with quick glances and adjust until the reticle is clear at first glance. This is a one-time adjustment. Because everyone's eyes are different, the ideal adjustment will vary from person to person.

The reticle details may appear small when not looking at the ranges they are set for, beyond 300 yards. Shooting at those ranges is best done from a well-supported position.

RETICLE ILLUMINATION

SLx 3X PRISM SCOPE

The illumination knob on the top of the scope is marked with numbers of increasing brightness from 1 to 11.

SLx 5X PRISM SCOPE

The illumination knob on the top of the scope is marked with numbers of increasing brightness from 1 to 5 in each direction from 0 or “off”. There are two “off” settings, divided between 5 red partial illumination settings and 5 green partial illumination settings.

The knob cap unscrews counter-clockwise, holding a CR2032 battery with the positive (+) side facing towards the cap. Reticle illumination at the lower settings is useful in low light situations like sunrise and sunset. The highest two settings are “daylight bright” settings. Using these settings in low light situations will overpower your eye’s ability to see the target and make the reticle appear distorted. The right amount of illumination creates a clear contrast between the reticle and your intended target, without straining the eye.

Illumination Knob/Battery Compartment

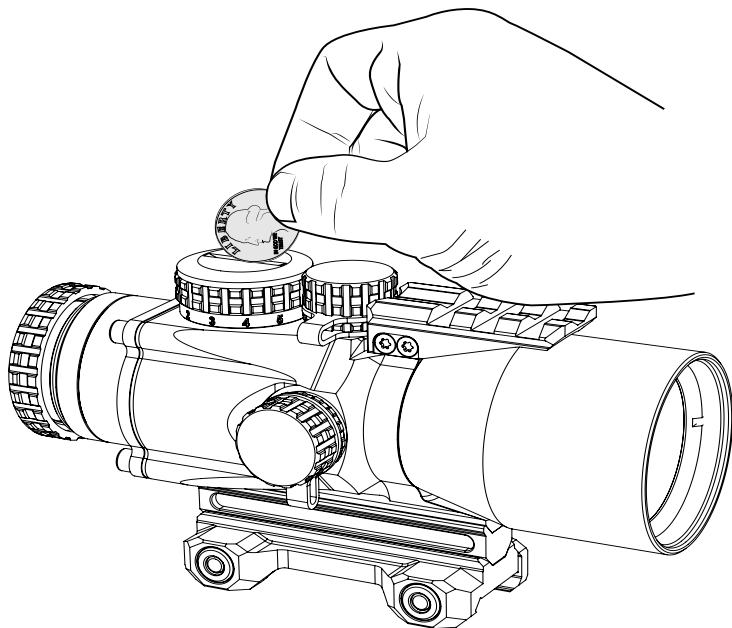

ZEROING

The optic is delivered in a centered position. Normally, this means that only small adjustments are necessary, providing that the base is properly aligned. Work your way to “zero” by adjusting each turret only a few clicks at a time. Remove the windage and elevation adjustment caps and turn them as follows:

- a. To move the point of impact to the right, turn the windage adjustment screw clockwise.
- b. To move the point of impact to the left, turn the windage adjustment screw counterclockwise.
- c. To move the point of impact up, turn the elevation adjustment screw clockwise.
- d. To move the point of impact down, turn the elevation adjustment screw counterclockwise.

Every click will shift the position of the dot by .25 MOA for 3x and .33 MOA for 5x. The maximum total adjustment range for both windage and elevation is 60 MOA for 3x and 35 MOA for 5x. If you suddenly encounter resistance, do NOT try to force the screw further, this can break the mechanism and render the sight unable to zero. Confirm zero by firing at least three shots at a zeroing target. After initial firing, check that the optic and mount are secure on your firearm. Check your impact points on the target to confirm accuracy and repeat until you are satisfied that the point of aim and the point of impact coincide at your desired range.

SLx 3x32 GEN III PRISM SCOPE SPECIFICATIONS

Magnification: 3x	Ocular Lens Diameter: 25mm	Total Elevation Adjustment: ≥ 60 MOA	Full Reticle Illumination in Red, Visible in Bright Sunlight
Objective Lens Diameter: 32 mm	Field of View: 31.5 feet @ 100 yards	Total Windage Adjustment: ≥ 60 MOA	Battery Life: 3,000 Hours
Eye Relief: 2.72 - 2.95"	Click Value: 0.25 MOA	Weight (With Battery, Without Lens Covers): 16.0 oz	Battery: 3v CR 2032
Exit Pupil: 10.3 mm	Illumination Settings: 11 Red	Length (w/o Lens Covers): 5.60"	Warranty: Lifetime Warranty

Specifications may vary and are subject to change without notice.

SLx 5x36 GEN III PRISM SCOPE SPECIFICATIONS

Magnification: 5x	Ocular Lens Diameter: 25mm	Total Elevation Adjustment: ≥ 35 MOA	Partial Reticle Illumination in Red & Green, Visible in Bright Sunlight
Objective Lens Diameter: 36 mm	Field of View: 18.4 feet @ 100 yards	Total Windage Adjustment: ≥ 35 MOA	Battery Life: 3,000 Hours
Eye Relief: 2.5 - 3"	Click Value: 0.33 MOA	Weight (With Battery, Without Lens Covers): 18.4 oz	Battery: 3v CR 2032
Exit Pupil: 7 mm	Illumination Settings: 5 Red / 5 Green	Length (w/o Lens Covers): 5.81"	Warranty: Lifetime Warranty

Specifications may vary and are subject to change without notice.

SLx 3x32 PRISM SCOPE FEATURES

- 11 Red Brightness Settings, Visible in Bright Sunlight
- 3,000 Hours Battery Life
- 3v CR 2032 Battery Included
- 32 mm Objective Lens Diameter, Not Clear Aperture
- Removable Top Picatinny Rail for Micro Reflex Sights
- Accommodation for Anti-Reflection Devices (ARD)
- High Strength Proprietary Riser Mount and Low Mount with Spacer to Achieve Different Heights
- 6061-T6 Main Body and Components with Hard Coat Anodizing
- Fully Nitrogen Purged, IP67 Waterproof and Dust Proof
- Improved Reticle Design that Features Chevron for Enhanced Aiming and the Addition of other Features to Improve Usability
- Designed and Manufactured to Handle Extreme Recoil
- Backed by our Lifetime Warranty

SLx 5x36 PRISM SCOPE FEATURES

- 5 Red / 5 Green Brightness Settings, Visible in Bright Sunlight
- 3,000 Hours Battery Life
- 3v CR 2032 Battery Included
- 36 mm Objective Lens Diameter, Not Clear Aperture
- Removable Top Picatinny Rail for Micro Reflex Sights
- Accommodation for Anti-Reflection Devices (ARD)
- High Strength Proprietary Riser Mount and Low Mount with Spacer to Achieve Different Heights
- 6061-T6 Main Body and Components with Hard Coat Anodizing
- Fully Nitrogen Purged, IP67 Waterproof and Dust Proof
- Improved Reticle Design that Features Chevron for Enhanced Aiming and the Addition of other Features to Improve Usability
- Designed and Manufactured to Handle Extreme Recoil
- Backed by our Lifetime Warranty

LENS CARE

Please do not use any organic solvent such as alcohol or acetone on your optic. First, blow dust or any foreign objects off of the lens. Then, use a soft cotton or microfiber lens cloth to clean any fingerprints or smears off the lens. Alternatively, you may use a piece of professional lens paper for further cleaning, if necessary.

 **WARNING:** Always ensure your firearm is unloaded (chamber empty and magazine removed) before installing optics or accessories.

 **WARNING:** Improper installation of firearm parts or accessories may result in death or serious personal injury. If you are not properly trained in the installation of these parts, have them installed by a gunsmith or armorer.

REMEMBER: THE FOUR RULES OF FIREARMS SAFETY

1. Treat every firearm as if it were loaded.
2. Never let your muzzle cover anything you are not willing to destroy.
3. Keep your finger off the trigger until your sights are on target.
4. Be sure of your target and what is behind it.

WARNING

- **INGESTION HAZARD:** This product contains a button cell or coin battery.
- **DEATH** or serious injury can occur if ingested.
- A swallowed button cell or coin battery can cause **INTERNAL CHEMICAL BURNS** in as little as **2 HOURS**.
- **KEEP** new and used batteries **OUT OF REACH OF CHILDREN**.
- **SEEK IMMEDIATE MEDICAL ATTENTION** if a battery is suspected to be swallowed or inserted inside any part of the body.



- Remove and immediately recycle or dispose of used batteries according to local regulations and keep away from children. Do NOT dispose of batteries in household trash or incinerate.
- Even used batteries may cause severe injury or death.
- Call a local poison control center for treatment information.
- Non-rechargeable batteries are not to be recharged.
- Do not force discharge, recharge, disassemble, heat above (manufacturer's specified temperature rating) or incinerate. Doing so may result in injury due to venting, leakage or explosion resulting in chemical burns.
- Ensure the batteries are installed correctly according to polarity (+ and -).
- Do not mix old and new batteries, different brands or types of batteries, such as alkaline, carbon-zinc, or rechargeable batteries. Remove and immediately recycle or dispose of batteries from equipment not used for an extended period of time according to local regulations.
- Always completely secure the battery compartment. If the battery compartment does not close securely, stop using the product, remove the batteries, and keep them away from children.



LIFETIME WARRANTY

Your Primary Arms SLx 3x32 & 5x36 Gen III Prism Scope is covered by the Primary Arms Lifetime Warranty. If a defect due to materials or workmanship, or even normal wear and tear has caused your product to malfunction, Primary Arms will either repair or replace your product. You can find more details about our lifetime warranty at www.primaryarmsoptics.com.

Email: info@primaryarmsoptics.com

Toll-free at 855-774-2767

www.primaryarmsoptics.com

For more information on these optics, go to:
<http://primaryarmsoptics.com/product-category/prism-scopes/>